



Lightcloud Luminaire Controller

LCLC3/D10

WE'RE HERE TO HELP :

1 (844) LIGHTCLOUD

1 (844) 544-4825

support@lightcloud.com

Hello

Lightcloud is a wireless lighting control system. The Lightcloud Luminaire Controller is a remotely controlled switching and dimming device that can be installed into luminaires.

Product Features

Wireless Control & Configuration

Switching up to 3A

0-10V Dimming

Power Monitoring

Patent Pending

Contents

Actuator Module, P/N 24586

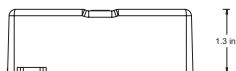
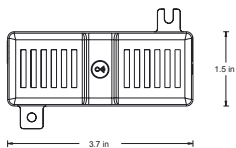
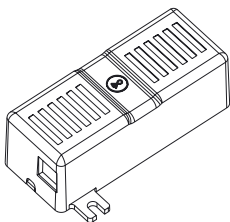

Radio Module, P/N 24572

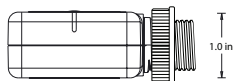
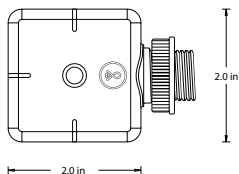
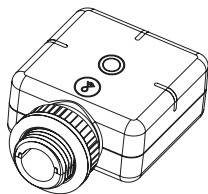

Wire Nuts



O-ring



Instruction Manual

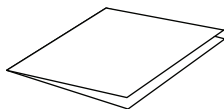

Specifications & Ratings

PART NUMBER

LCLC3/D10

INPUT

120/277VAC, 50/60Hz

CURRENT DRAW

<0.6W(Standby)-1W(Active)

LOAD SWITCHING CAPACITY

LED, CFL, Tungsten 120/277VAC 500W; Magnetic 120VAC 264VA, 277VAC 500VA; Resistive/Inductive 120VAC 500W

OPERATING TEMPERATURE:

-40°C to +50°C max temp

ACTUATOR MODULE OVERALL

DIMENSIONS:

3.7" x 1.5" x 1.3"

RADIO MODULE OVERALL

DIMENSIONS:

2" x 2" x 1"

WIRELESS RANGE

Line-of-Sight: 700 feet Obstructions: 70 feet

INDOOR USE ONLY

DAMP LOCATION

What You Need



Lightcloud Gateway

A Lightcloud installation requires at least one Lightcloud Gateway to manage your devices.

WE'RE HERE TO HELP:

1 (844) LIGHTCLOUD

or 1 (844) 544-4825

support@lightcloud.com

Setup & Installation

① Turn Off Power

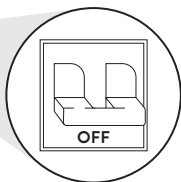
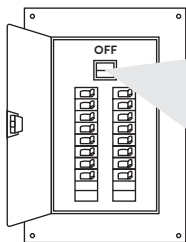

1a Find a Suitable Location

Use these guidelines when installing devices:

- If there is a clear line of sight between a Luminaire Controller and another Lightcloud device they can be placed up to 700 ft apart.
- If a Luminaire Controller and another Lightcloud device are separated by ordinary drywall construction, try to keep them within 70 ft. of each other.
- Brick, concrete and steel construction may require additional Lightcloud devices to go around the obstruction.

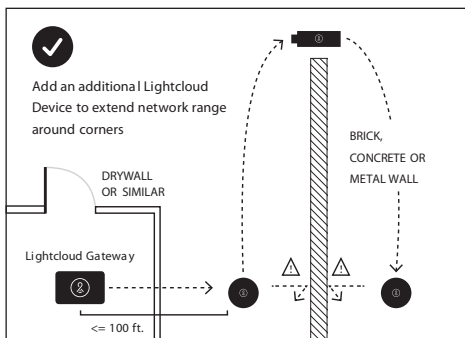

2 Install the Luminaire Controller

(For Luminaires Pre-Installed with the Luminaire Controller, Skip to Step 3)

2a Fixture Installation with Actuator Module Inside

If the interior of your luminaire can accommodate the dimensions of the actuator module, install the actuator module inside the housing, and attach the radio module to the outside of the housing via a knockout.

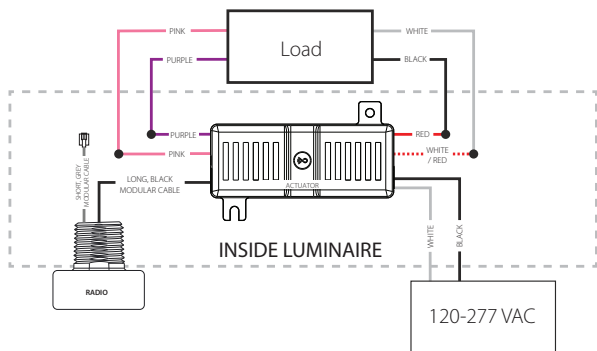

Setup & Installation (cont'd)

2b Installation with Junction Box

If the interior of your luminaire cannot accommodate the actuator module, the Luminaire Controller can be mounted into a junction box, with the radio module always outside any metal enclosure.

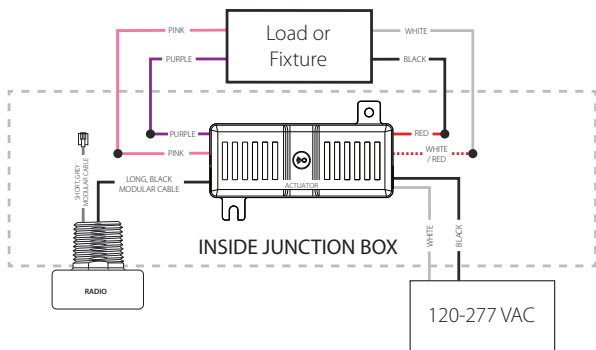

3 Install Luminaire

Install the luminaire with integrated Luminaire Controller as normal, allowing for any room to accommodate the external radio module of the LCLC3/D10.

4 Labeling Your Device

When installing devices, it's important to keep track of their Device IDs, installation locations, panel/circuit #s, dimming function, and any additional notes. To organize this information, use the Lightcloud Installer Application (A) or Device Table (B).

4a Lightcloud Installer Application

Install the LC Installer Application:

LC Installer is available for iOS and Android.

Scan & Install Lightcloud Devices:

Scan each device and assign to a room. It's recommended that each device is scanned just before or just after being wired so no devices are missed. The more notes that are given, the easier it is to commission the system.

Send to RAB:

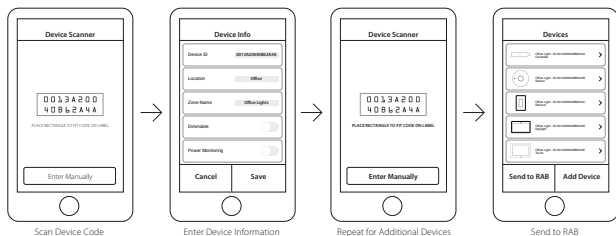

Once all of the devices have been added and organized, submit the information for commissioning.

Setup & Installation *(cont'd)*

4b Device Table

Two Lightcloud Device Tables are provided with each Gateway: one that you can attach to your panel and one to hand off to a building manager. Attach the Device Identification stickers included with each device to a row, then write in additional information, such as Zone name, Panel/Circuit Number, and whether or not a Zone uses dimming.

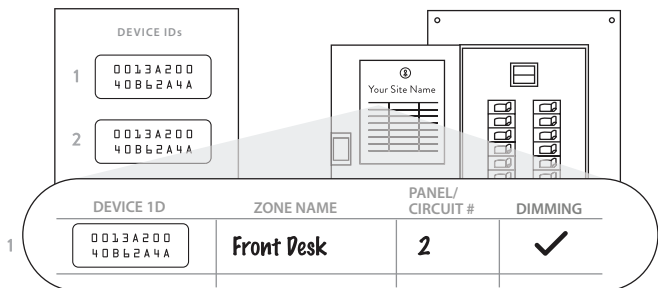

5 Power Up

To add devices to your Lightcloud network, call RAB at 1 (844) LIGHTCLOUD, or email us at support@lightcloud.com

6 Confirm Device Connectivity

Confirm Status Indicator is Solid Green *(see details on the right)*

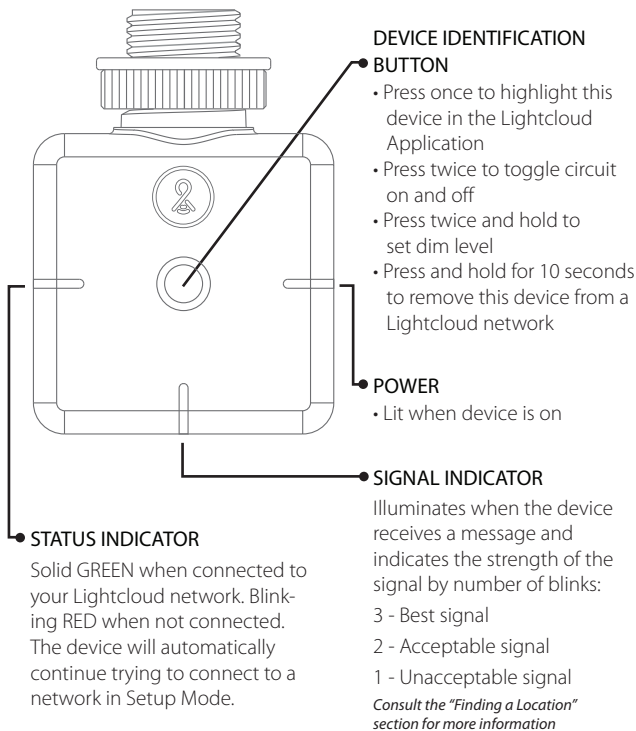

7 Commission Your Devices

Log on to www.lightcloud.com or call
1 (844) LIGHTCLOUD

Functionality

Configuration

All configuration of Lightcloud products may be performed using the Lightcloud web Application, or by calling RAB.

WE'RE HERE TO HELP:

1 (844) LIGHTCLOUD

or 1 (844) 544-4825

support@lightcloud.com

Power Measurement

The Lightcloud Luminaire Controller is capable of measuring the power usage of the attached luminaire. In order to utilize this function, the neutral wire of the load must be connected to the white-red neutral wire. If the white-red neutral line cannot be used, it should be tied to the regular neutral wires (i.e. all neutral wires joined).

Power Loss Detection

If mains power to the Controller is lost, the device will detect this and alert the Lightcloud Application.

Emergency Default

If communication is lost, the Controller may optionally fall back to a specific state, such as turning the attached luminaire on.

[Warning: Any wires not in use must be capped off or otherwise insulated.]

FCC Information:

This device complies with Part 15 of the FCC Rules. Operation is subject to the following two conditions: 1. This device may not cause harmful interference, and 2. This device must accept any interference received, including interference that may cause undesired operation.

Note: This device has been tested and found to comply with the limits for Class B digital devices pursuant to Part 15 Subpart B, of the FCC rules. These limits are designed to provide reasonable protection against harmful interference in a residential environment. This equipment generates, uses, and can radiate radio frequency energy, and if not installed and used in accordance with the instruction manual, may cause harmful interference to radio communications. However, there is no guarantee that interference will not occur in a particular installation. If this equipment does cause harmful interference to radio or television reception, which can be determined by turning the equipment of and on, the user is encouraged to try and correct the interference by one or more of the following measures:

- *Reorient or relocate the receiving antenna.*
- *Increase the separation between the equipment and receiver.*
- *Connect the equipment into an outlet on a circuit different from that to which the receiver is connected.*
- *Consult the dealer or an experienced radio/TV technician for help.*

To comply with the FCC's RF exposure limits for general population / uncontrolled exposure, this transmitter must be installed to provide a separation distance of at least 20 cm from all persons and must not be co-located or operating in conjunction with any other antenna or transmitter.

CAUTION: Changes or modifications to this equipment not expressly approved by RAB Lighting may void the user's authority to operate this equipment.



It's powerful and
flexible, yet easy to use
and install. Learn more at
lightcloud.com

1 (844) LIGHTCLOUD

1 (844) 544-4825

support@lightcloud.com

RAB[®]

© 2022 RAB Lighting, Inc